



Operation

This is a precision weighing instrument, handle with care. Slide the pan/cover as shown to expose the display and keys. The pan/cover can slide to either Weighing  or Storage  positions.

NOTE: For Weighing, slide pan/cover all the way until a click is heard (pan locks into weighing position). Do not apply excessive force when sliding the pan, and do not press on the pan or try to remove it.

Once pan is locked into Weighing position, the scale is ready for use. Batteries are already installed.

>0< On/Off/Zero

Press this key to turn the scale on. This key is also used to rezero the display. To turn the scale off, press and hold this key until the display indicates OFF, then release.

Unit/Cal

Press this key to change the weighing unit. Press and hold to begin calibration.

Weighing

Slide the pan/cover to Weighing until it locks into position. Place the scale on a firm level surface. Turn the scale on. When the * symbol is displayed the scale is ready for use. Place sample on the pan and read the displayed result. The * indicator appears when the reading is stable. If using a container, press >0< to tare the container before adding material. If the capacity of the scale is exceeded, an E will appear on the display and the load should be removed immediately.

Calibration

Refer to Specifications for the correct calibration weights.

1. Press and hold **Unit/Cal** until "CAL" is displayed, then release it.
2. Press >0<. The required weight will appear in grams.
3. Place the appropriate weight on the pan, then press >0<.
4. "PASS" will be displayed when calibration is complete.

Note: If "CAL E" is displayed a calibration error has occurred (for example, an incorrect weight was used or the pan was disturbed). Repeat the procedure.

To access the batteries, slide the pan/cover to battery position  as shown and press the release tab. Install battery with (+) facing up.



Specifications

Model	PS121T	PS251T
Capacity (g)	120	250
Readability (g)	0.1	0.1
Calibration weight	100g	200g
Weighing Units	g, thk, tsg, trc	
Tare range	to capacity by subtraction	
Stabilization time	2 seconds	
Optimum operating temp.	65° - 77°F/18° - 25°C	
Power requirements	2-CR2032 Lithium batteries (included)	
Auto Shut-off	2 minutes no activity	
Overload indication	[E]	

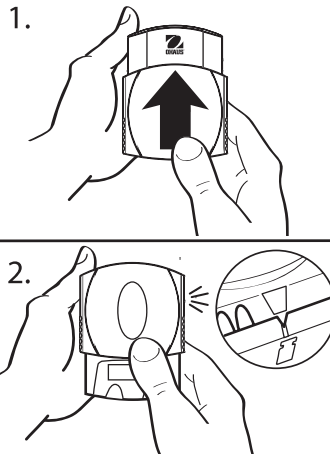
Register your scale under *Warranty Registration* at www.ohaus.com



操作

这是非常精确的称量器具，应小心使用。把称盘/护盖如图所示推到露出显示器和按键。称盘/护盖可以推到称重  或存放  位置。

注意： 称重时，把称盘/护盖一直推到听见“卡嚓”声为止（此时称盘锁定在称重位置）。推动称盘时不得用力过大，也不可以压称盘或试图将其移动。称盘一旦锁定在称重位置时，就可以使用秤。电池已经安装。

>0< On/Off/Zero

按此键开启秤盘电源。此键也用来将显示重新归零。要关闭秤盘时，按下此键不放，一直到显示“OFF”才放松。

UNIT/Cal

按此键更换秤重单位。按下后不放以开始校准。

称重

把称盘/护盖推到锁定在称重位置。把称盘推到“称重”(Weighing)位置。把称盘放到稳定又平坦的表面。开启秤盘电源。显示 * 符号时可以使用秤盘。把样品放到称盘上并查看重量显示。重量读值稳定时会出现 * 显示器。如果使用容器，则在加入秤重物之前先按 >0< 以秤皮重。如果秤重物的重量超出秤盘的负载量，则会在显示器出现 E，此时应立即把该秤重物取出。

校准

有关正确的校准重量，请参考“规格”。

1. 把 **UNIT/Cal** 按下后不放，直到显示“CAL”才放松。
2. 按 >0<。需要的重量会以公克显示。
3. 把适当的重量放到称盘上，然后按 >0<。
4. 校准完成时会显示“PASS”。

注意： 若显示“CALE”，表示发生校准错误（比如，使用的重量不正确，或称盘受到摇动）。此时应重复秤重程序。

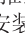
更换电池时，把称盘/护盖如图所示推到电池位置 ，然后按电池匣将其打开。安装电池时(+)面朝上。

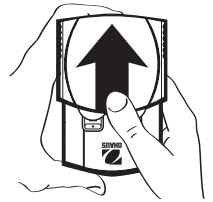

规格

型号	PS121T	PS251T
负载量 (g)	120	250
可读重量 (g)	0.1	0.1
校准重量	100g	200g
秤重单位	g, thk, tsg, trc	
去皮范围	减到负载量	
稳定时间	2 seconds	
最适操作温度.	65° - 77°F/18° - 25°C	
使用电源	2-CR2032 锂电池 (含)	
自动关闭	没有秤重逾 2分钟	
超载显示	[E]	

请到 www.ohaus.com，在保证书登记 (*Warranty Registration*) 部分登记您的秤盘。

LIMITED WARRANTY

Ohaus products are warranted against defects in materials and workmanship for duration of the warranty. During the warranty period Ohaus will repair, or, at its option, replace any component(s) that proves to be defective at no charge, provided that the product is returned, freight prepaid, to Ohaus. This warranty does not apply if the product has been damaged by accident or misuse, exposed to radioactive or corrosive materials, has foreign material penetrating to the inside of the product, or as a result of service or modification by other than Ohaus. In lieu of product registration, the warranty period shall begin on the date of shipment to the authorized dealer. No other express or implied warranty is given by Ohaus Corporation. Ohaus Corporation shall not be liable for any consequential damages. As warranty legislation differs from state to state and country to country, please contact Ohaus or your local Ohaus dealer for further details.

有限保证

Ohaus 的产品在保证期限内材料和工艺没有瑕疵。Ohaus 将在保证期限内免费修理或选择更换任何证明有瑕疵的部件，但要把该产品寄到 Ohaus 并已付回邮。如果产品因意外事故或使用不当、暴露到放射性或腐蚀性材料、外来异物进入产品内，或由不是 Ohaus 的人员维修或改造而引起损伤，则不适用此保证。取代产品登记，保证期限将在产品货运到授权的代理商的日期开始。Ohaus Corporation 不给予任何其它明示或暗示的保证。Ohaus Corporation 对间接性的损失将不负任何责任。由于法律要求的保证内容因州和郡而不同，详细内容请联系 Ohaus 或您当地的 Ohaus 代理商。

NOTE: This equipment has been tested and found to comply with the limits for a Class B digital device, pursuant to Part 15 of the FCC Rules. These limits are designed to provide reasonable protection against harmful interference in a residential installation. This equipment generates, uses and can radiate radio frequency energy and, if not installed and used in accordance with the instructions, may cause harmful interference to radio communications. However, there is no guarantee that interference will not occur in a particular installation. If this equipment does cause harmful interference to radio or television reception, which can be determined by turning the equipment off and on, the user is encouraged to try to correct the interference by one or more of the following measures:

- Reorient or relocate the receiving antenna.
- Increase the separation between the equipment and receiver.
- Connect the equipment into an outlet on a circuit different from that to which the receiver is connected.
- Consult the dealer or an experienced radio/TV technician for help

This device complies with Part 15 of the FCC Rules. Operation is subject to the following two conditions: (1) this device may not cause harmful interference, and (2) this device must accept any interference received, including interference that may cause undesired operation.

This Class B digital apparatus complies with Canadian ICES-003.

Cet appareil numérique de la classe B est conforme à la norme NMB-003 du Canada.



Ohaus PS Series Scales With Tails

Ohaus PS 系列秤盘（具银两标示）

Operating Manual 使用手册



Ohaus Corporation
19A Chapin Road,
P.O. Box 2033
Pine Brook, NJ 07058, USA
Tel: (973) 377-9000
Fax: (973) 944-7177
www.ohaus.com
With offices worldwide / 办事处分布全球



* 8 0 1 0 4 0 6 5 *

P/N 80104065 © Ohaus Corporation 2005, all rights reserved /
保留所有权利

Printed in China/ 在中国印制